



PNP Series Sealed Pushbutton Switch

Pushbutton

A

STANDARD VIEW

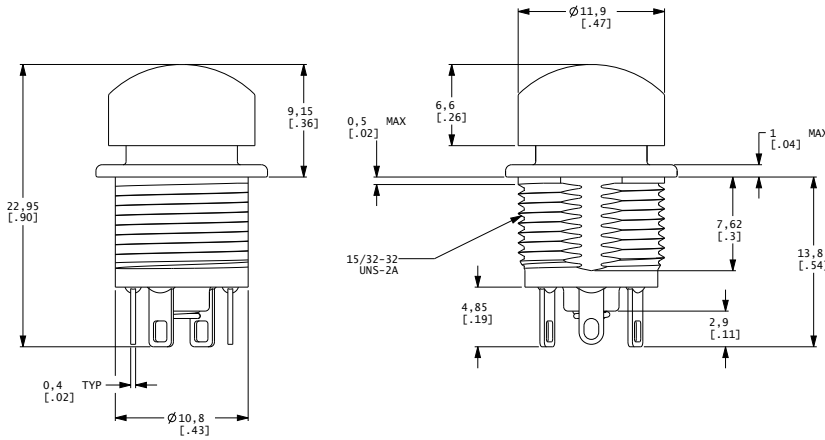

ELECTRICAL SCHEMATIC

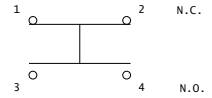

OPERATING FORCE

OPTION CODE	OPERATING FORCE
3	3 N
8	8 N

ACTUATOR STYLE

S STANDARD

E EXTENDED (D HOUSING STYLE ONLY)

N NO CAP

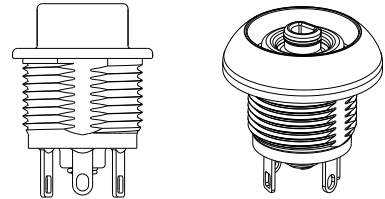
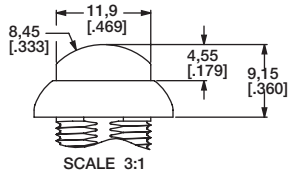
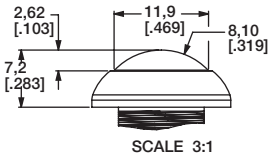

ACTUATOR COLOR

OPTION CODE	ACTUATOR COLOR
0	No color
1	White
2	Black
3	Red
4	Orange
5	Yellow
6	Green
7	Blue
9	Gray

* Cap may be ordered separately

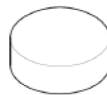

PART NUMBER

285E01000	White
285E02000	Black
285E03000	Red
285E04000	Orange
285E05000	Yellow
285E06000	Green
285E07000	Blue
285E09000	Gray
824D01000	White
824D02000	Black
824D03000	Red
824D04000	Orange
824D05000	Yellow
824D06000	Green
824D07000	Blue
824D09000	Gray





PNP Series Sealed Pushbutton Switch

Pushbutton
A

HOUSING COLOR

OPTION CODE	COLOR
2	Black (STD)

CIRCUIT

W SPST NC - Double Break

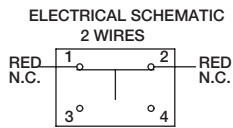

Y SPST NO - Double Break

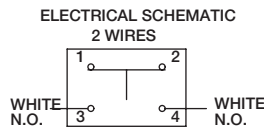

C SPDT - Double Break

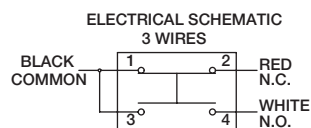

C SPDT - Double Break

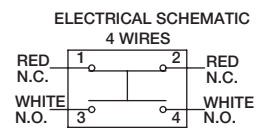

TERMINATION

02 PC PIN

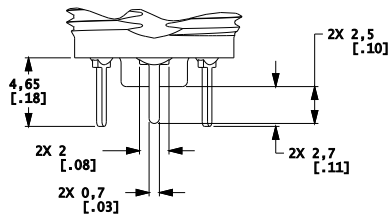

03 SOLDER LUG (STD)

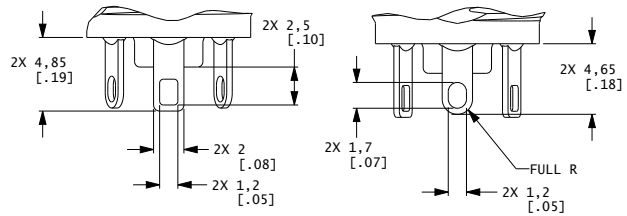

W2 2 x 12" 22 AWG UL1569 wire (overmolded)

W3 3 x 12" 22 AWG UL1569 wire (overmolded)

W4 4 x 12" 22 AWG UL1569 wire (overmolded)

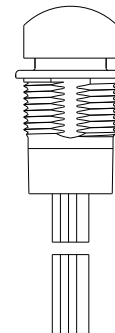
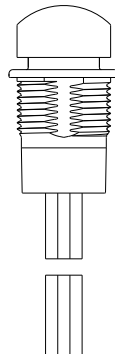
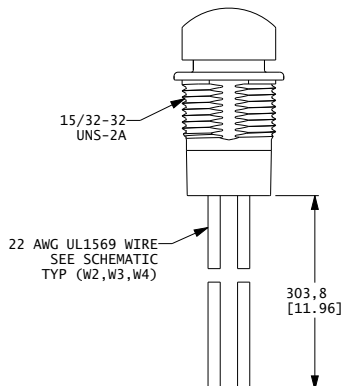



CONTACT MATERIAL

OPTION CODE	CONTACT MATERIAL
Q	Silver (STD)
G	Gold over silver

TERMINAL SEAL

E EPOXY

All models are epoxy sealed

HARDWARE

HEX NUT

707100201 Nickel-plated

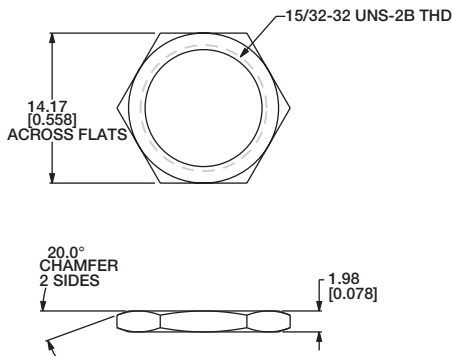

LOCKWASHER

700302202

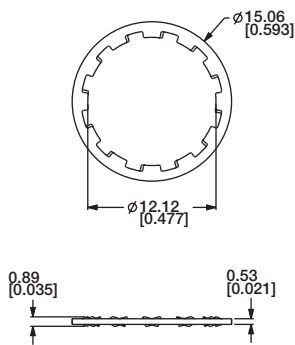

PANEL GASKET

851D02000

