

# R13 Round Rocker Switches 10A 250Vac



- ▶ Miniature round rocker switch
- ▶ Ratings up to 10A, 250Vac
- ▶ Single & double pole
- ▶ Illuminated & non-illuminated, neon and LED
- ▶ Choice of actuators
- ▶ Matching indicator
- ▶ Panel cut out: 20.2 dia.

## Approvals and specifications



SP 10(4)A 250Vac T85 1E4



DP 10(4)A 250Vac T85 1E4



UL CSA SP 16A 125Vac & 10A 250Vac  
 UL CSA DP 16A 125Vac, 10A 250Vac, 10A 28Vdc  
 UL 85°C, file E67774(S), CSA file LR45128

### RoHS compliant

Single pole has  $\mu$  contact gap. Technical data on pages 4 & 5.

### Special products

Are made to order and can be supplied with a range of body and rocker/lens colours, print & lamp voltage.  
 Call sales for availability to your special requirements.

## R13 112A AAA

TERMINAL FUNCTION ROCKER BODY PRINT, COLOUR, VOLTAGE ETC

### PRODUCT DETAILS



SP ON - OFF  $\mu$

**Cat no.**  
R13 112A AAA

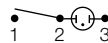

SP ON - OFF  $\mu$   
Lit 230V

**Cat no.**  
R13 112B NAC



SP ON - OFF  $\mu$

**Cat no.**  
R13 112A AAB

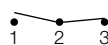

SP ON - ON  $\mu$

**Cat no.**  
R13 112C AAA

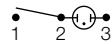

SP ON - OFF  $\mu$   
Lit 230V

**Cat no.**  
R13 112B NAA

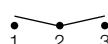

SP ON - OFF - ON  $\mu$

**Cat no.**  
R13 112D AAA

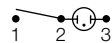

SP ON - OFF  $\mu$   
Lit 230V

**Cat no.**  
R13 112B NAB



SP ON - OFF  $\mu$   
(Momentary ON)

**Cat no.**  
R13 208F AAA\*



DP ON - OFF

**Cat no.**  
R13 244A AAA



DP ON - OFF  
Lit 230V

**Cat no.**  
R13 244B NAA

### DIMENSIONS (mm)

#### Panel cut-out

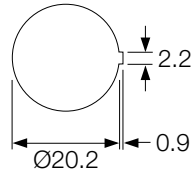

Snap fixing into panel thickness up to 3.0

#### Single pole

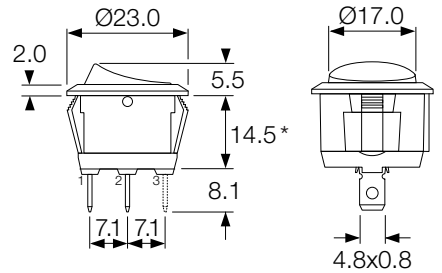

\* R13 208F has 12.5mm deep body

#### Double pole

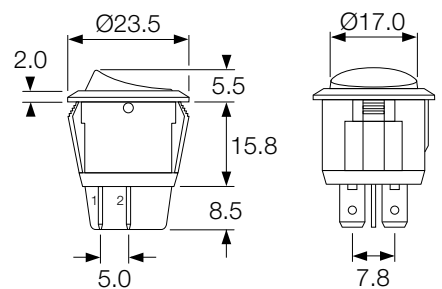



R13 112B NAA



R13 112A AAA



R13 112A2 ---

**PRODUCT  
DETAILS**



SP ON - OFF  $\mu$   
Bright colour ON signal  
**Cat no.**  
**R13 112A2 - -**

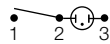
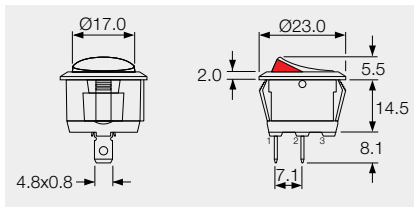

SP ON - OFF  $\mu$   
Lit Window  
**Cat no.**  
**R13 112B2 - -**

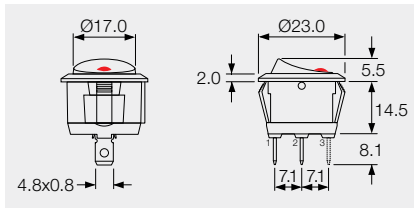

SP ON - OFF  $\mu$   
Paddle tip has red LED  
**Cat no.**  
**R13 112LP - -**

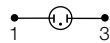
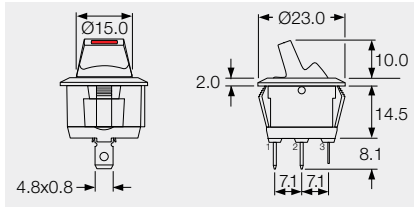

Indicator light  
**Cat no.**  
**R9 92B - - -**

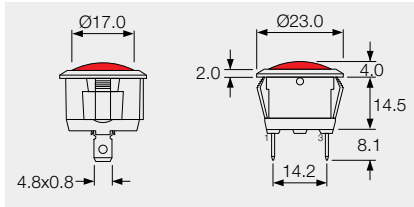

**PANEL CUT-OUT (mm)**

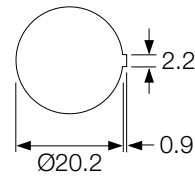

Snap fixing into  
2.0 to 3.0mm panels

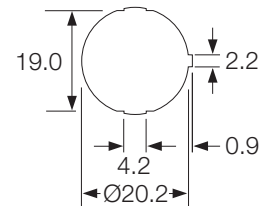

Snap fixing into  
0.7 to 3.0mm panels



**Protective cover L188**

Snaps on to bodies (not R13 211 or R13 112LP), this reduces maximum acceptable panel thickness by 0.8mm.