

380 Push Button Snap Action Switches 16(4)A 250Vac



383 2510 K BL



383 2510 RR 383 2510 PR

- ▶ Snap action switches
- ▶ Ratings up to 16A, 250Vac
- ▶ Round and rectangular buttons



16(4)A 250Vac 5E4 T85



16A 125/250Vac 3/4hp T85 50E3

125V 1/2 HP, 250V 3/4 HP, 0.4A 125Vdc, 0.2A 250Vdc



RoHS compliant

Approvals apply to switch mechanism only.
μ contact gap.

| | | | | |
|----------|-----------------------|----------------|----------------|-------------------------------|
| ■ | Blank for switch only | | | |
| E | R Red | B Black | | |
| P | R Red | B Black | | |
| K | R Red | B Black | BL Blue | G Green W White |
| R | R Red | B Black | BL Blue | G Green W White |
| M | R Red | B Black | BL Blue | G Green W White |

383 2510 K BL

TERMINAL FUNCTION ACTUATOR ACTUATOR
CODE CODE CODE COLOR

▶ **ORDER FORMAT**

| ▶ TERMINAL | ▶ FUNCTION | ▶ ACTUATOR | BODY | ▶ OPTIONS |
|--|---------------------------------------|--|--|---|
| <p>383</p> <p>6.3 x 0.8</p> <p>12.0</p> | <p>ON - ON (momentary 1 side)</p> | <p>R Rectangular bezel</p> <p>P Short</p> <p>K with satin chrome bezel</p> <p>M with nylon bezel</p> | <p>Panel Cut-out</p> <p>Panel thickness Both nuts 2.5mm No backnut 4.0mm</p> | <p>Color Call factory for custom colors A full range is available for large orders</p> |

Dimensions (mm)

R

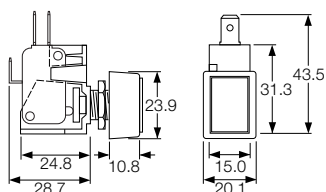

P & E

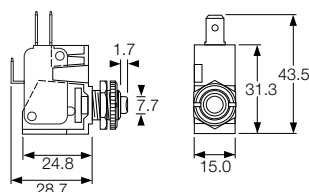

K & M

